

Washing Machine BLDC Motor – Technical Specifications



EEM30A-4LSQD

Application : Front Loading Washing Machine

BLDC motor for Fully Automatic washing machine with duty cycle up to 60% with 6.5-7.5 Kg Load with a spin speed up to 1000 rpm is possible.

Rated Voltage : 220 / 240 V AC 50/60 Hz

Output Power : 300 Watts

Speed : 14000 RPM

Efficiency : 85 %

Slot pole ratio : 12 stator slot/8 rotor pole

Stack Length : 30mm

Belt drive : Poly-V-Belt profile J

Feedback System : Sensored or Sensorless

Pulley Ratio : 10-15 (According to customer Requirement)

Insulation : Class F/H

Armature winding : Aluminium Winding

Direction : CW / CCW

Motor Weight : 3.5 Kg

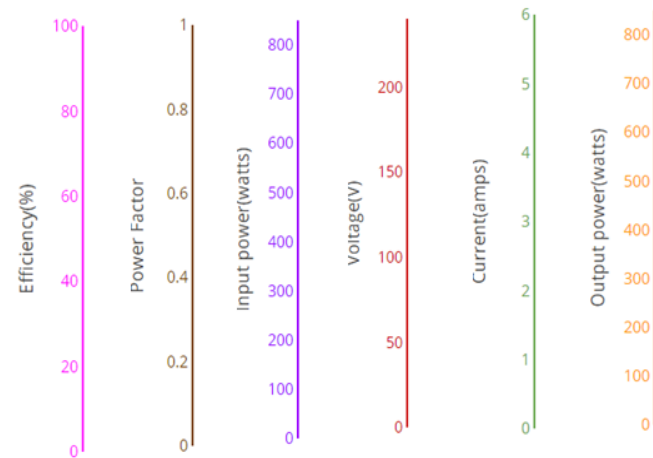
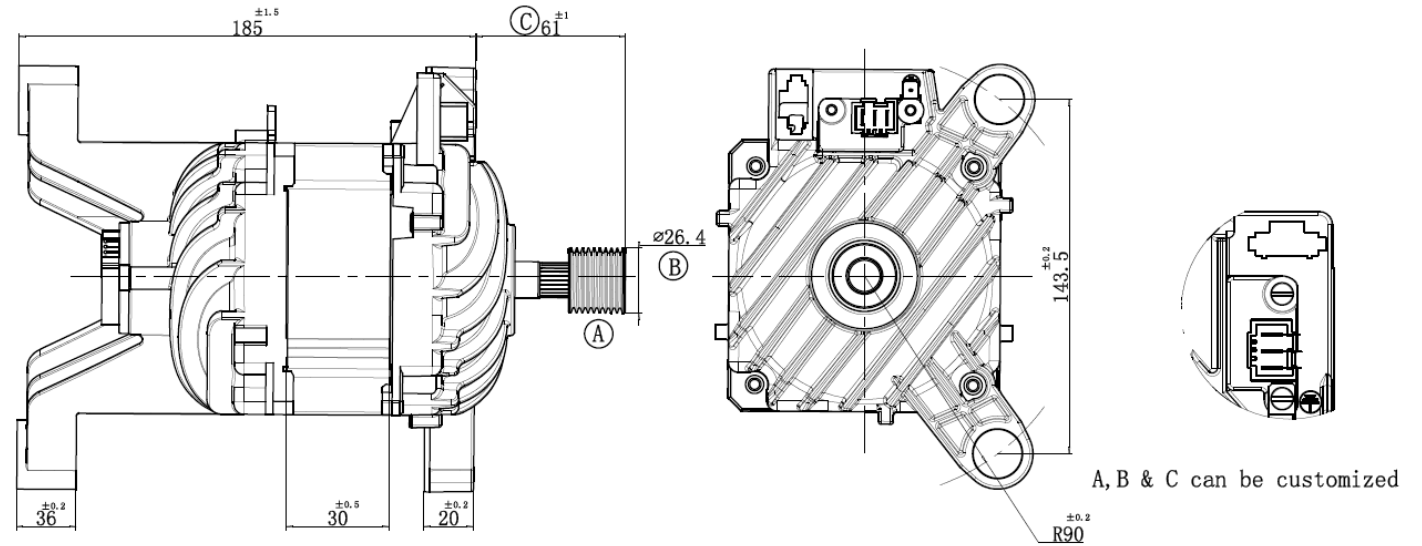

30mm BLDC

